

Garcia MITCHELL 304-305

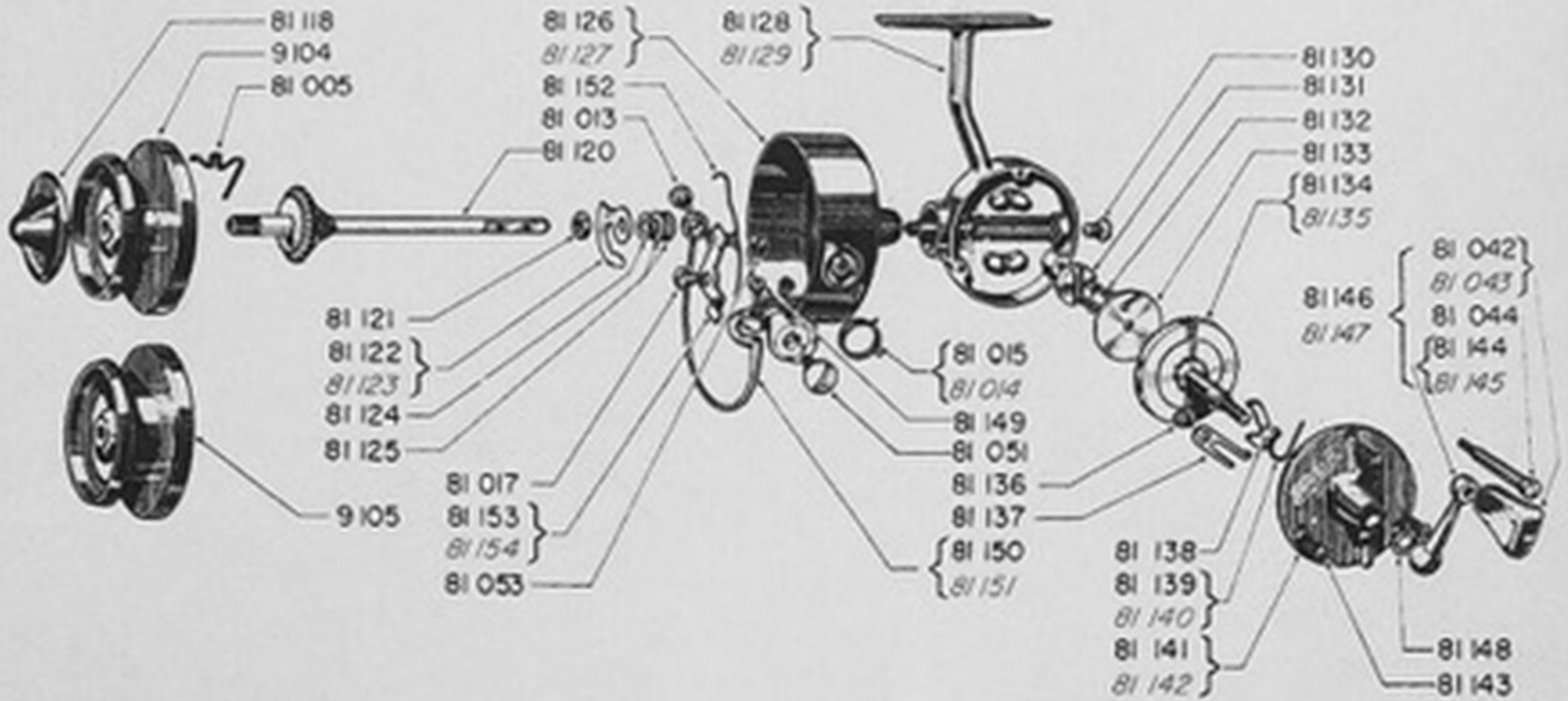

ムサシ オーバーホール作業用資料: リールのメンテは "ムサシ オーバーホール" で検索

Items in red for left hand model 305

*Use only the number of shims required for smoothest performance

| No. | Part Name | Price | No. | Part Name | Price | No. | Part Name | Price |
|-------------|---------------------------|-------|-------------|--|-------|-------------|-------------------------------|-------|
| 9104 (2) | Spool, Large | 1.75 | 81123 (34L) | Bail Trip (305) | .25 | 81139 (47) | Anti Reverse Dog Spring (304) | .10 |
| 9105 (25) | Spool, Small | 1.75 | 81124 (35) | Bail Trip Washer | .10 | 81140 (47L) | Anti Reverse Dog Spring (305) | .10 |
| 9213 | Manual Pick-up (304 only) | 1.75 | *81125 (36) | Shims To Adjust Rotating Head (set of 3) | .30 | 81141 (48) | Coverplate (304) | 2.00 |
| 81005 (73) | Click Spring | .10 | 81126 (38) | Rotating Head (304) | 3.25 | 81142 (49L) | Coverplate (305) | 2.00 |
| 81013 (37) | Bail Screw No. 2 | .15 | 81127 (38L) | Rotating Head (305) | 3.25 | 81143 (50) | Cover Screw (ea.) | .10 |
| 81014 (58L) | Bail Spring (305) | .15 | 81128 (39) | Housing (304) | 3.75 | 81144 (94) | Handle Shank (304) | .75 |
| 81015 (58) | Bail Spring (304) | .15 | 81129 (39L) | Housing (305) | 3.75 | 81145 (94L) | Handle Shank (305) | .75 |
| 81017 (51) | Trip Lever Screw | .10 | 81130 (40) | Lube Port Screw | .10 | 81146 (60) | Handle Complete (304) | 1.25 |
| 81042 (62) | Handle Knob (304) | .25 | 81131 (63) | Oscillation Slide | .15 | 81147 (60L) | Handle Complete (305) | 1.25 |
| 81043 (62L) | Handle Knob (305) | .25 | 81132 (64) | Oscillation Slide Screw (ea.) | .05 | 81148 (59) | Handle Spacer, (Optional) | .10 |
| 81044 (61) | Handle Knob Screw | .10 | 81133 (65) | Crosswind Cam | .25 | 81149 (56) | Line Guide | .30 |
| 81051 (55) | Bail Screw No. 1 | .20 | 81134 (43) | Drive Gear (304) | 2.00 | 81150 (54) | Bail (304) | 3.00 |
| 81053 (57) | Line Guide Screw | .10 | 81135 (43L) | Drive Gear (305) | 2.00 | 81151 (54L) | Bail (305) | 3.00 |
| 81118 (1A) | Drag Adjusting Knob | .25 | 81136 (44) | Anti Reverse Cam Screw | .10 | 81152 (53) | Trip Lever Spring | .10 |
| 81120 (5) | Axle | 1.00 | 81137 (45) | Anti Reverse Cam | .10 | 81153 (52) | Trip Lever (304) | .35 |
| 81121 (33) | Hex Nut | .10 | 81138 (46) | Anti Reverse Dog | .15 | 81154 (52L) | Trip Lever (305) | .35 |
| 81122 (34) | Bail Trip (304) | .25 | | | | | | |

PARTS AND SERVICE AVAILABLE AT THE FOLLOWING REGIONAL FACTORY REPAIR DEPOTS:

FACTORY SERVICE
RODS, REELS AND PARTS

THE GARCIA SERVICE DEPARTMENT
329 ALFRED AVENUE
TEANECK, NEW JERSEY 07666

THE CONOLON CORPORATION
1111 EAST McFADDEN STREET
SANTA ANA, CALIFORNIA 92705

SILICOTE SALES DIVISION
520 WEST 14th AVENUE
OSHKOSH, WISCONSIN 54902

J. K. CLARK COMPANY
ACO SPORTSMEN SERVICE
13501 VAN DYKE
DETROIT, MICHIGAN 48234

REEL SERVICE AND PARTS

NATE BUELL SERVICE CORPORATION
5013 N.E. 42nd STREET
PORTLAND, OREGON 97218

HARRY C. MILLER CO., INC.
257 PARK AVENUE SOUTH
NEW YORK, NEW YORK 10010

SHERMAN LOYD SALES COMPANY
4737 GREENVILLE AVENUE
DALLAS, TEXAS 75206